

120/240 VOLT FLOODLIGHTS

One (1) floodlight and mounting:

Part Number: BP.33001V	1 x 500W	Halogen 120V, Fireco
Part Number: BP.33001	1 x 500W	Halogen 240V, Fireco
Part Number: BP.33001T	1 x 500W	Halogen 120V, Tele-Lite
Part Number: BP.33001F	1 x 750W	Halogen 120V, FRC Optimum
Part Number: BP.33001H	1 x 750W	Halogen 120V, Havis MagnaFire
Part Number: BP.33001A	1 x 750W	Halogen 120V, Akron
Weight: 10 lbs.		

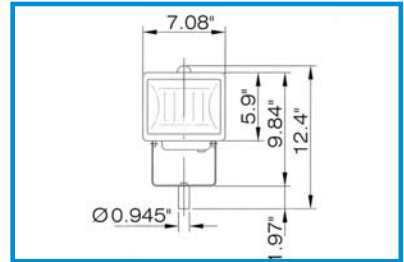

Two (2) floodlights mounted above crossbar:

Part Number: BP.33004V	2 x 500W	Halogen 120V, Fireco
Part Number: BP.33004	2 x 500W	Halogen 240V, Fireco
Part Number: BP.33004T	2 x 500W	Halogen 120V, Tele-Lite
Part Number: BP.33004F	2 x 750W	Halogen 120V, FRC Optimum
Part Number: BP.33004H	2 x 750W	Halogen 120V, Havis MagnaFire
Part Number: BP.33004A	2 x 750W	Halogen 120V, Akron
Weight: 15 lbs.		

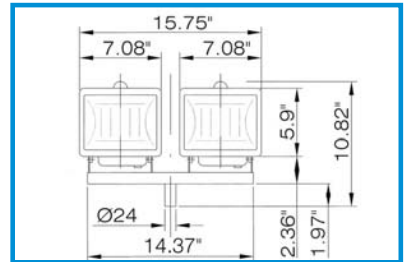

Two (2) floodlights mounted below crossbar:

Part Number: BP.33007V	2 x 500W	Halogen 120V Fireco
Part Number: BP.33007	2 x 500W	Halogen 240V Fireco
Part Number: BP.33007T	2 x 500W	Halogen 120V, Tele-Lite
Part Number: BP.33007F	2 x 750W	Halogen 120V, FRC Optimum
Part Number: BP.33007H	2 x 750W	Halogen 120V, Havis MagnaFire
Part Number: BP.33007A	2 x 750W	Halogen 120V, Akron
Weight: 15 lbs.		

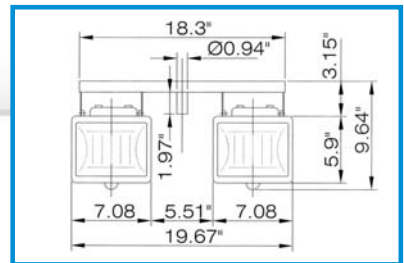

Three (3) floodlights mounted above crossbar:

Part Number: BP.33010V	3 x 500W	Halogen 120V, Fireco
Part Number: BP.33010	3 x 500W	Halogen 240V, Fireco
Part Number: BP.33010T	3 x 500W	Halogen 120V, Tele-Lite
Part Number: BP.33010F	3 x 750W	Halogen 120V, FRC Optimum
Part Number: BP.33010H	3 x 750W	Halogen 120V, Havis MagnaFire
Part Number: BP.33010A	3 x 750W	Halogen 120V, Akron
Weight: 25 lbs.		

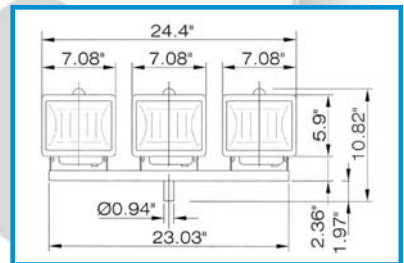

Four (4) floodlights – (2) above and (2) below crossbar:

Part Number: BP.33011V	4 x 500W	Halogen 120V, Fireco
Part Number: BP.33011	4 x 500W	Halogen 240V, Fireco
Part Number: BP.33011T	4 x 500W	Halogen 120V, Tele-Lite
Part Number: BP.33011F	4 x 750W	Halogen 120V, FRC Optimum
Part Number: BP.33011H	4 x 750W	Halogen 120V, Havis MagnaFire
Part Number: BP.33011A	4 x 750W	Halogen 120V, Akron
Weight: 30 lbs.		

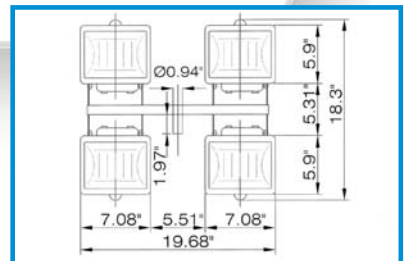

Note: Some of the floodlight options listed may differ from the drawings shown

120/240 VOLT FLOODLIGHTS

One (1) floodlight and mounting:

- Part Number: BP.33021V 1 x 1000W Halogen 120V, Fireco
 - Part Number: BP.33020 1 x 1500W Halogen 240V, Fireco
 - Part Number: BP.33021 1 x 1000W Halogen 240V, Fireco
 - Part Number: BP.33020T 1 x 1500W Halogen 240V, Tele-Lite
 - Part Number: BP.33020F 1 x 1500W Halogen 240V, FRC Optimum
 - Part Number: BP.33021H 1 x 900W HIR 240V, Havis MagnaFire
- Weight: 10 lbs.

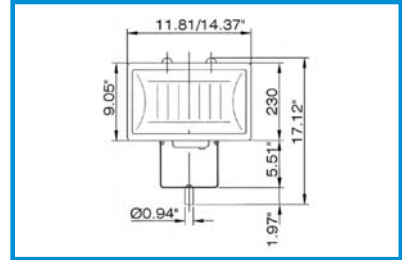

Two (2) floodlights mounted above crossbar:

- Part Number: BP.33023V 2 x 1000W Halogen 120V, Fireco
 - Part Number: BP.33023 2 x 1000W Halogen 240V, Fireco
 - Part Number: BP.33032 2 x 1500W Halogen 240V, Fireco
 - Part Number: BP.33032T 2 x 1500W Halogen 240V, Tele-Lite
 - Part Number: BP.33032F 2 x 1500W Halogen 240V, FRC Optimum
 - Part Number: BP.33032H 2 x 900W HIR 240V, Havis MagnaFire
- Weight: 20 lbs.

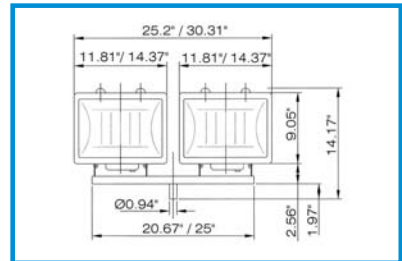

Two (2) floodlights mounted below crossbar:

- Part Number: BP.33025V 2 x 1000W Halogen 120V, Fireco
 - Part Number: BP.33025 2 x 1000W Halogen 240V, Fireco
 - Part Number: BP.33031 2 x 1500W Halogen 240V, Fireco
 - Part Number: BP.33031T 2 x 1500W Halogen 240V, Tele-Lite
 - Part Number: BP.33031F 2 x 1500W Halogen 240V, FRC Optimum
 - Part Number: BP.33031H 2 x 900W HIR 240V, Havis MagnaFire
- Weight: 20 lbs.

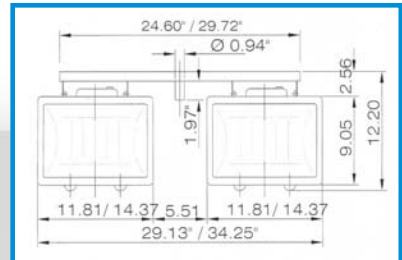

Four (4) floodlights (2) above and (2) below crossbar:

- Part Number: BP.33027V 4 x 1000W Halogen 120V, Fireco
 - Part Number: BP.33027 4 x 1000W Halogen 240V, Fireco
 - Part Number: BP.33030 4 x 1500W Halogen 240V, Fireco
 - Part Number: BP.33030T 4 x 1500W Halogen 240V, Tele-Lite
 - Part Number: BP.33030F 4 x 1500W Halogen 240V, FRC Optimum
 - Part Number: BP.33030H 4 x 900W HIR 240V, Havis MagnaFire
- Weight: 35 lbs.

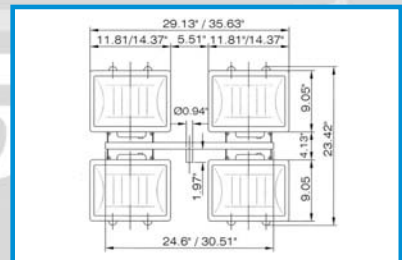

360 DEGREE MOUNTING OF 120V FLOODLIGHTS

Three (3) floodlights 360 degree lighting - top mounting:

- Part Number: BP.33012V 3 x 500W Halogen 120V, Fireco
- Part Number: BP.33012T 3 x 500W Halogen 120V, Tele-Lite
- Part Number: BP.33012F 3 x 500W Halogen 120V, FRC Optimum
- Part Number: BP.33012H 3 x 750W Halogen 120V, Havis MagnaFire

Weight: 25 lbs.

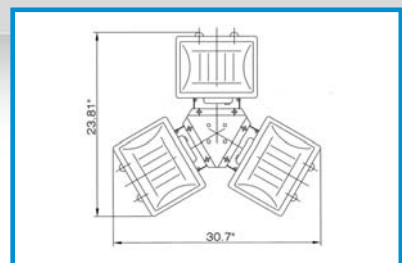

Note: Some of the floodlight options listed may differ from the drawings shown

360 DEGREE MOUNTING OF 120 VOLT FLOODLIGHTS

Three (3) floodlights 360 degree lighting - top mounting:

- Part Number: BP.33029 3 x 1000W Halogen 240V, Fireco
 Part Number: BP.33029T 3 x 1000W Halogen 240V, Tele-Lite
 Part Number: BP.33029F 3 x 1000W Halogen 240V
 FRC Optimum
 Part Number: BP.33029H 3 x 900W Halogen 240V,
 Havis MagnaFire

Weight: 30 lbs.

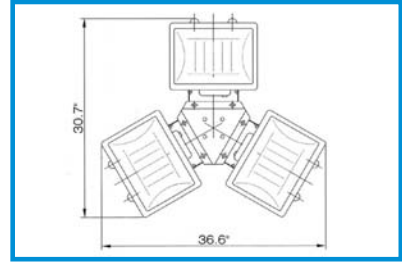

HPS AND MH 120 VOLT FLOODLIGHTS

One (1) floodlight and mounting:

- Part Number: BP.33041 1 x 250W HPS 240V
 Part Number: BP.33061 1 x 250W MH 240V
 Weight: 20 lbs.

- Part Number: BP.33042 1 x 400W HPS 240V
 Part Number: BP.33062 1 x 400W MH 240V
 Weight: 30 lbs.

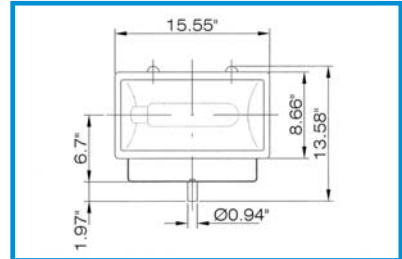

Two (2) floodlights mounted below crossbar:

- Part Number: BP.33043 2 x 250W HPS 240V
 Part Number: BP.33063 2 x 250W MH 240V
 Weight: 45 lbs.

- Part Number: BP.33044 2 x 400W HPS 240V
 Part Number: BP.33064 2 x 400W MH 240V
 Weight: 60 lbs.

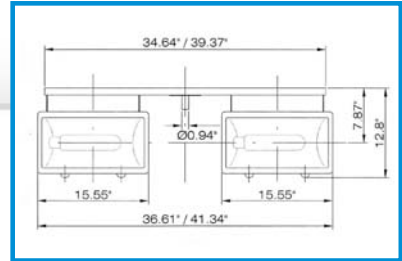

Two (2) floodlights mounted above crossbar:

- Part Number: BP.33045 2 x 250W HPS 240V
 Part Number: BP.33065 2 x 250W MH 240V
 Weight: 45 lbs.

- Part Number: BP.33046 2 x 400W HPS 240V
 Part Number: BP.33066 2 x 400W MH 240V
 Weight: 60 lbs.

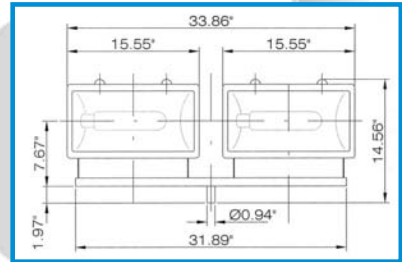

HPS AND MH 120 VOLT FLOODLIGHTS

One (1) floodlight and mounting:

- Part Number: BP.33081 1 x 250W HPS 24V
 Part Number: BP.33086 1 x 250W MH 24V
 Weight: 15 lbs.

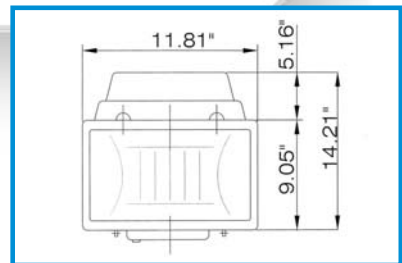

Note: Some of the floodlight options listed may differ from the drawings shown

HPS AND MH 120 VOLT FLOODLIGHTS

Two (2) floodlights mounted above crossbar:

Part Number: BP.33071 2 x 70W HPS 12V
 Part Number: BP.33072 2 x 70W MH 12V
 Weight: 15 lbs.

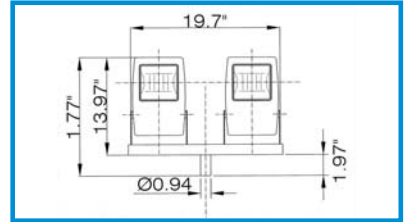

Two (2) floodlights mounted below crossbar:

Part Number: BP.33073 2 x 70W HPS 12V
 Part Number: BP.33074 2 x 70W MH 12V
 Weight: 15 lbs.

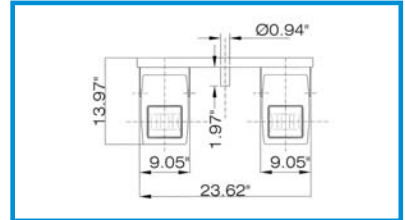

12 VOLT FLOODLIGHTS

Two (2) floodlights mounted below crossbar:

Part Number: BP.33003 2 x 100W Xenophot 12V Fireco
 Part Number: BP.33002F 2 x 150W HID 12V, FRC Optimum
 Part Number: BP.33001H 2 x 70W HID 12V, Havis Shields
 Part Number: BP.33005A 2 x 150W HID 12V, Akron
 Part Number: BP.33091 2 x 35W Xenon HID, 12V
 Weight: 10 to 20 lbs.

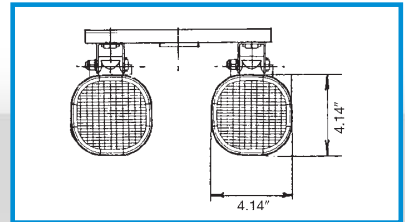

Two (2) floodlights mounted above crossbar:

Part Number: BP.33006 2 x 100W Xenophot 12V Fireco
 Part Number: BP.33005F 2 x 150W HID 12V, FRC Optimum
 Part Number: BP.33005H 2 x 150W HID 12V, Havis Shields
 Part Number: BP.33005A 2 x 150W HID 12V, Akron
 Part Number: BP.33092 2 x 35W Xenon HID, 12V
 Weight: 10 to 20 lbs.

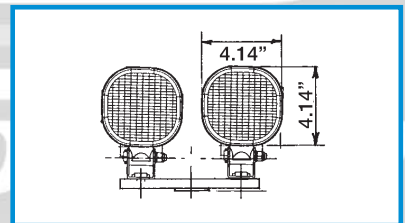

Four (4) floodlights mounted above crossbar:

Part Number: BP.33095 4 x 35W Xenon HID, 12V
 Weight: 25 to 30 lbs.

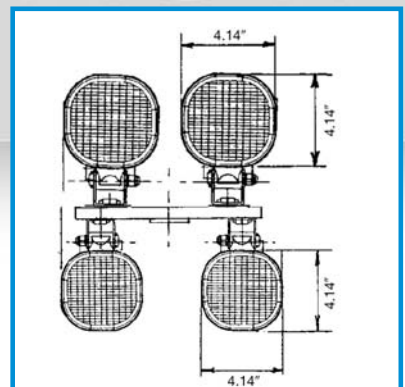

Note: Some of the floodlight options listed may differ from the drawings shown

CODE: HPS: High pressure sodium
 MH: Metal halide
 HID: High intensity discharge

SELECTION CHART FOR ORDERING LIGHTWEIGHT/PNEUMATIC TELESCOPIC TOWERS

CA5	5	01	P	B
TOWER DIAMETER	NUMBER OF SECTIONS	EXTENDED TOWER HEIGHT	TYPE OF TOWER	INTERNAL ELECTRICAL CABLE

Diameter and type of tower

CA	2 -1/2"	100 Series
CN	2 -1/2"	200 Series
CP	3 -1/8"	300 Series
CO	2 -1/2"	400 Series
CO	3 -1/8"	500 Series
CM	4"	600 Series

Type of tower

P Manual or pneumatic with locking collars

H With hand pump and locking collars

Number of sections

52	2	Sections
53	3	Sections
54	4	Sections
55	5	Sections
56	6	Sections
57	7	Sections
58	8	Sections
59	9	Sections
50	10	Sections
51	11	Sections

Electric Cables

None Without electric cable

B (see page 117)

C (see page 117)

F (see page 117)

H (see page 117)

100 Series - Model CA55 - 2-1/2" Diameter and 5 Sections

CA 55		01	02	03
Code P/H	Extended height	13' 1-1/2"	14' 9 -1/8"	16' 4-1/2"
	Retracted height	46 1/16"	50"	53 -7/8"

Legend

Code P: Manual or pneumatic with locking collars

Code H: Hand pump system with locking collars

SPECIAL LIGHTWEIGHT TOWERS



200 & 300 SERIES TOWERS
AVAILABLE WITH ELECTRICAL
OUTLETS AND LOCKING DEVICES.

TEMPEST

PAINTED FINISHES AVAILABLE.